

1. Transparent polycarbonate joint-covers for 10mm glassboards

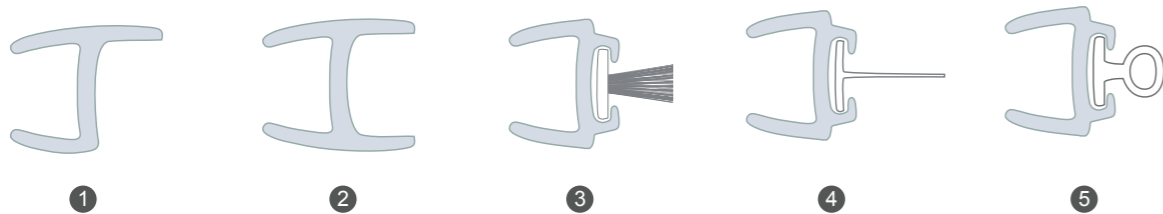

- 1 "chair" joint-cover
- 2 "H" joint-cover
- 3 joint-cover with brush (several sizes)
- 4 joint-cover with thin elastic gasket
- 5 joint-cover with "bubble" elastic gasket

2. Aluminum joint-covers for 10mm glassboards

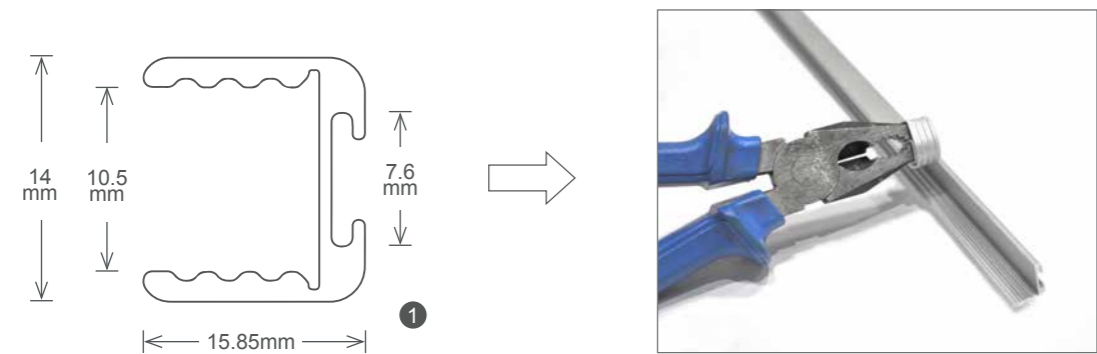

"П" joint-cover cut:

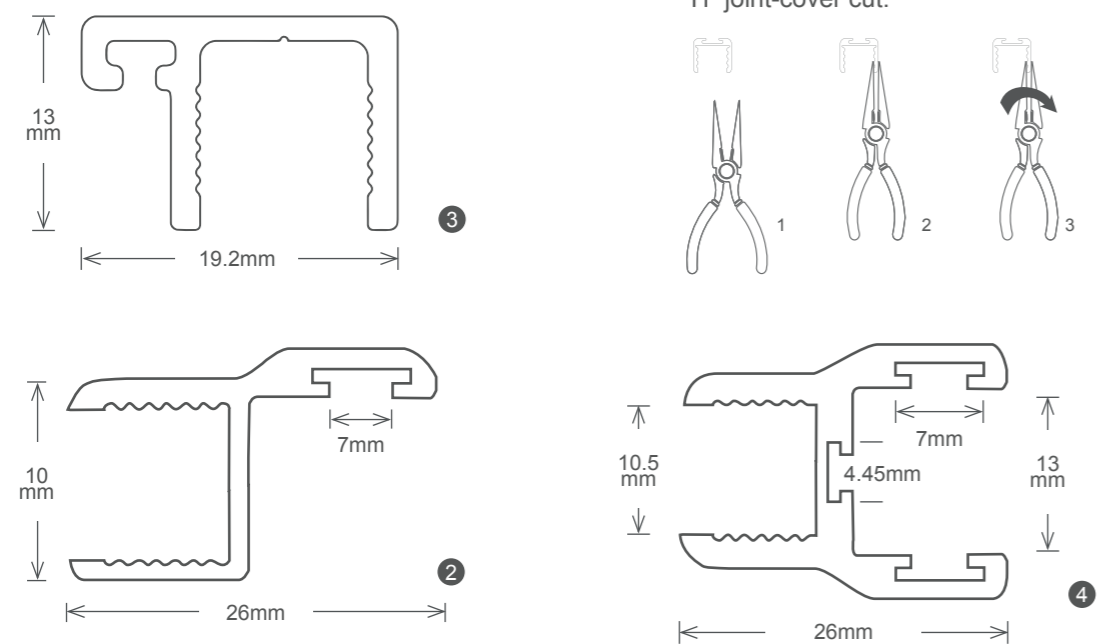
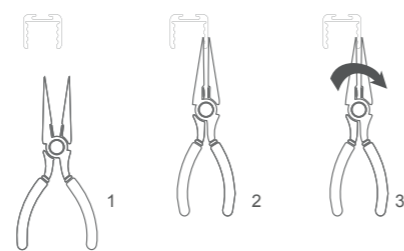

- 1 "П" joint-cover
- 2 "hook" joint-cover
- 3 "chair" joint-cover
- 4 "H" joint-cover

3. Aluminum joint-covers for insulation at corners for 10mm glassboards

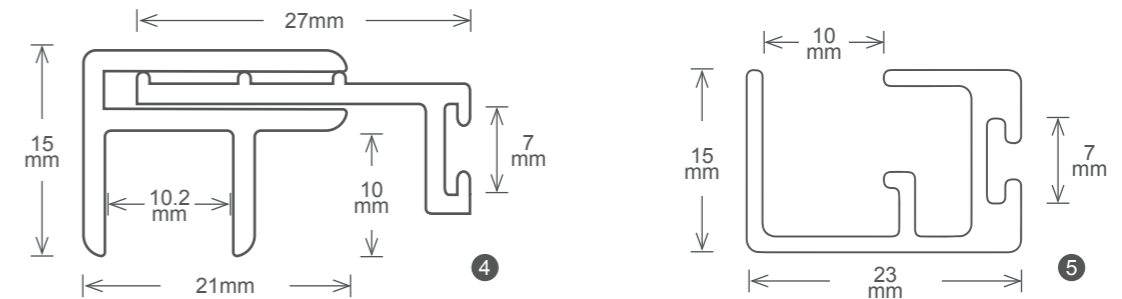

- 4 detachable joint-cover for corners
- 5 joint-cover for corners

4. Laths for fixed glassboard support

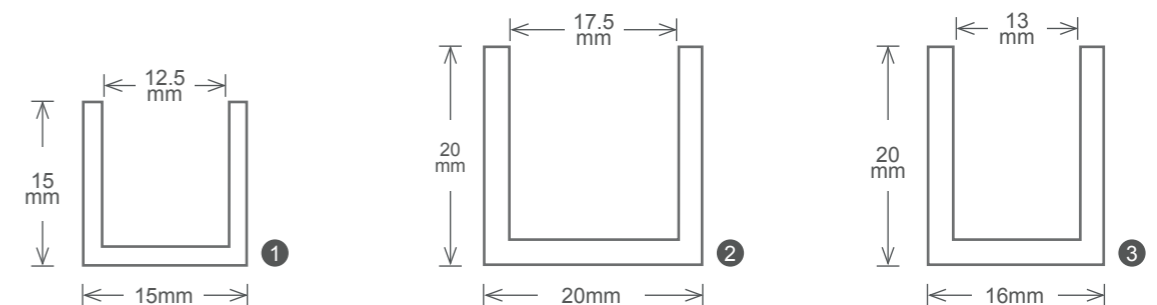

- 1 "П" lath 15x15 (5m rod)
- 2 "П" lath 20x20 (5m rod)
- 3 "П" lath 20x16 (5m rod)
- 4 "U20" profile with lid (5.5m rod)

- 5 detachable lath 20/25 (6m rod)
- 6 detachable lath 40/28 (6m rod)

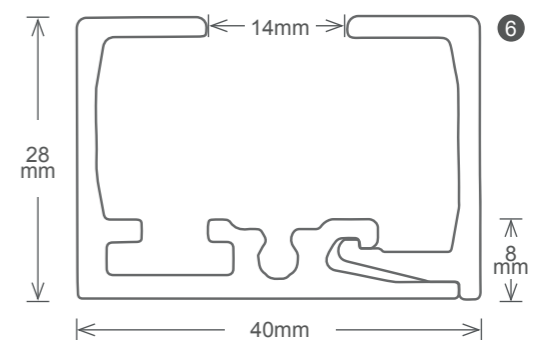
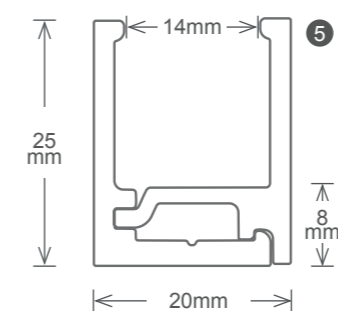
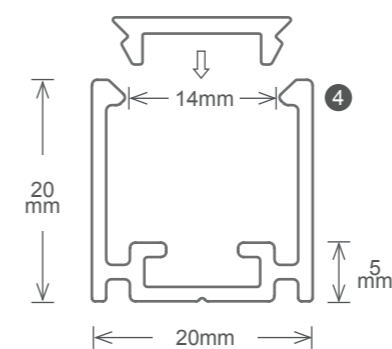

4. Aluminum profiles for watertightness on the flooring

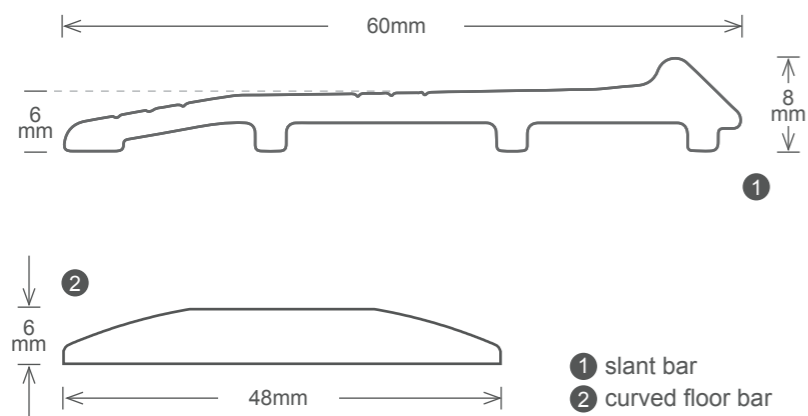

5. Latch nests

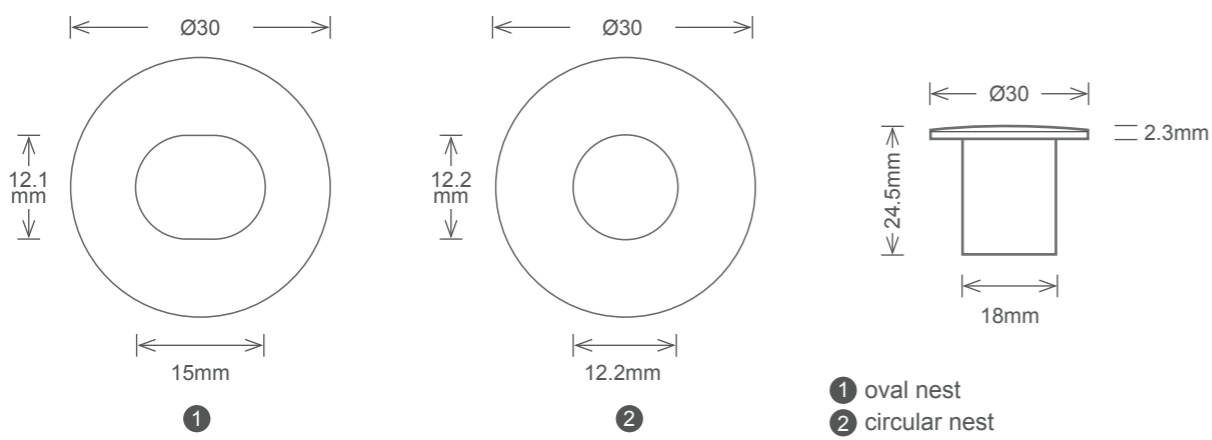

6. Recessed knobs

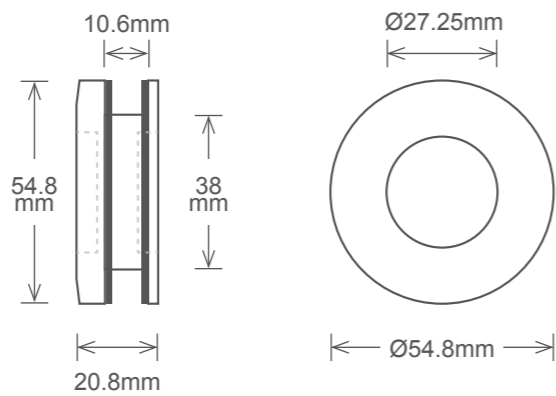

7. Ball knobs

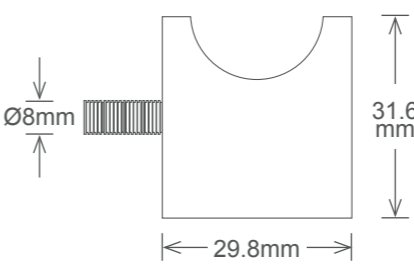
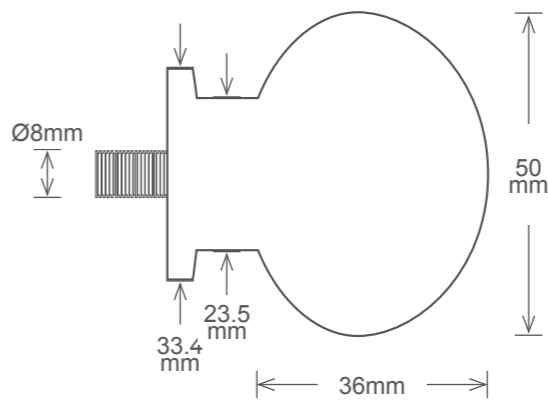
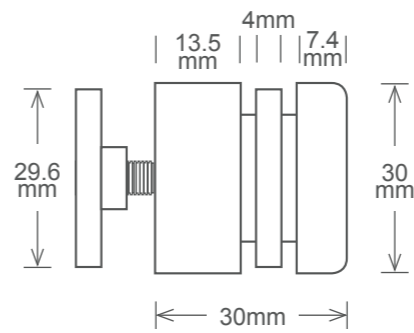
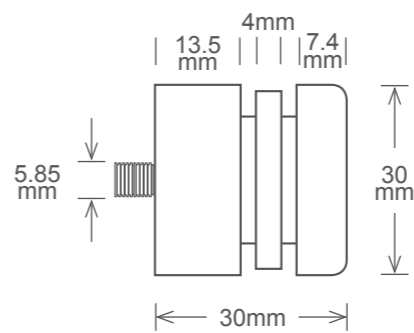

8. Stainless steel knobs and bars

H-shaped bars

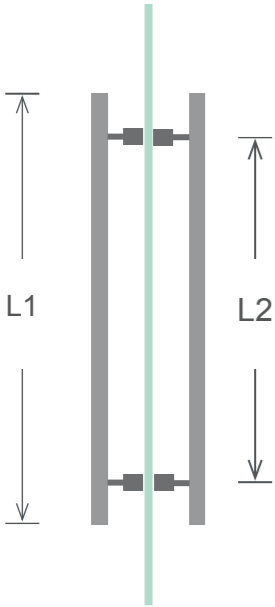

description	L1(cm)	L2 (cm)
Ø30 x 400	40	25
Ø30 x 500	50	36
Ø30 x 600	60	40
Ø30 x 800	80	60
Ø30 x 1000	100	80
Ø30 x 1200	120	100
Ø30 x 1400	140	120
Ø30 x 1600	160	130
Ø30 x 1800	180	140
Ø30 x 2000	200	150



Single bars

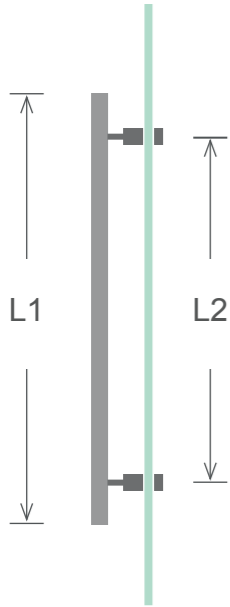

Description	L1(cm)	L2 (cm)
Ø30 x 400	40	25
Ø30 x 500	50	36
Ø30 x 600	60	40
Ø30 x 800	80	60
Ø30 x 1000	100	80
Ø30 x 1200	120	100
Ø30 x 1400	140	120
Ø30 x 1600	160	130
Ø30 x 1800	180	140
Ø30 x 2000	200	150

Stainless steel 304 Ø30 tube satin texture, 1.2mm thickness.
Bars can be constructed with additional mounting fitments.
Bars with different dimensions can be manufactured upon request (Ø20, Ø25, Ø40) as well as with rectangular dimensions (30x30, 40x40, 60x20)

9. Locks for 8-10mm glassboards

Type G oval lock

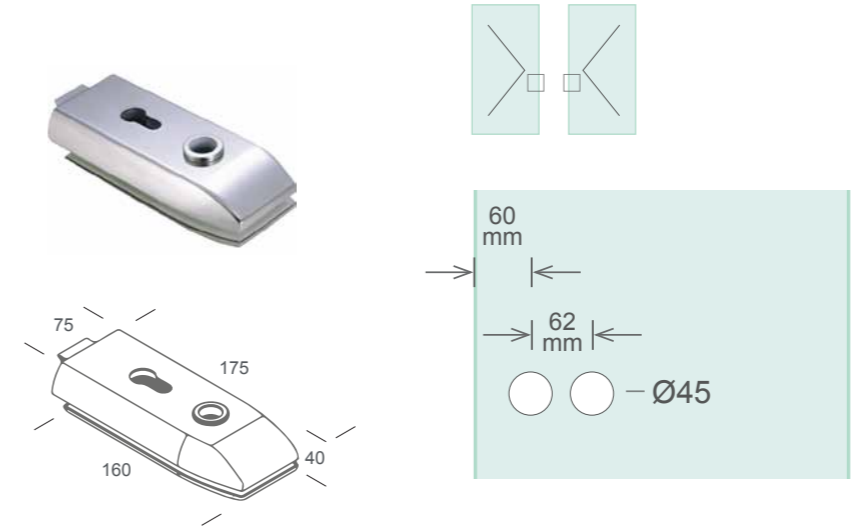

Type R square lock

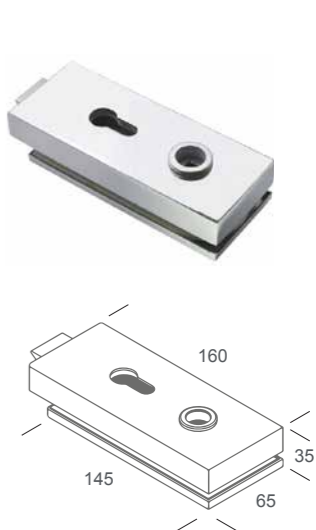

Type Gw oval lock with indicator

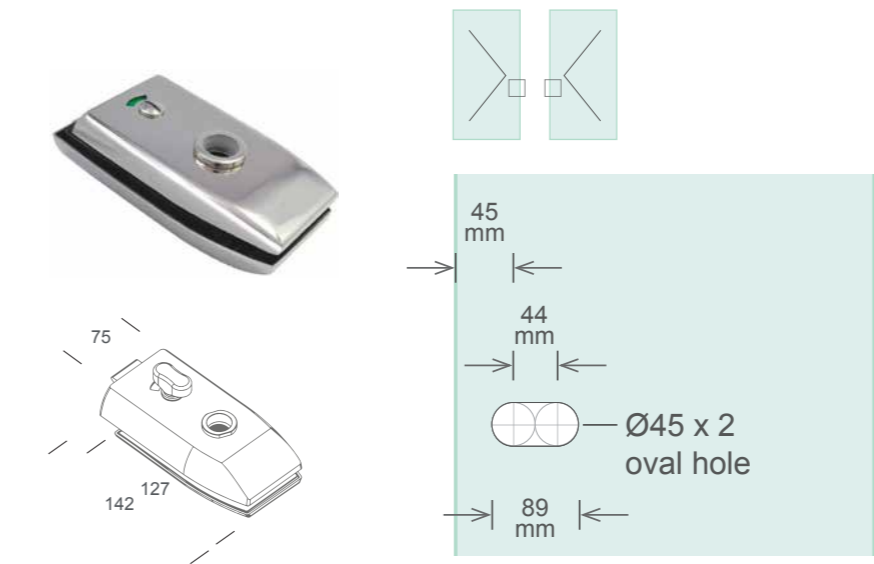

Type Rw square lock with indicator

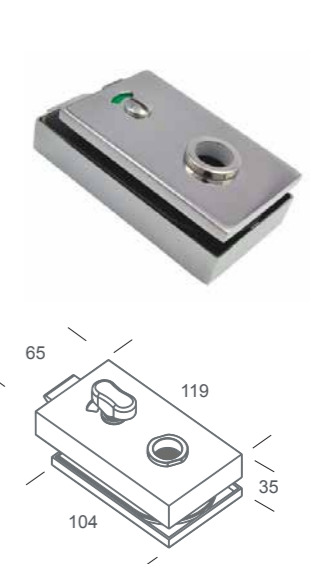

Type Gs oval cross lock

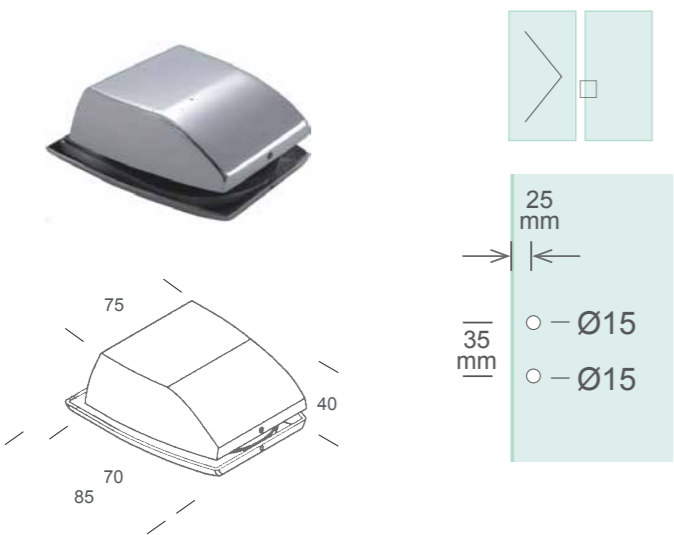

Type Rs square cross lock

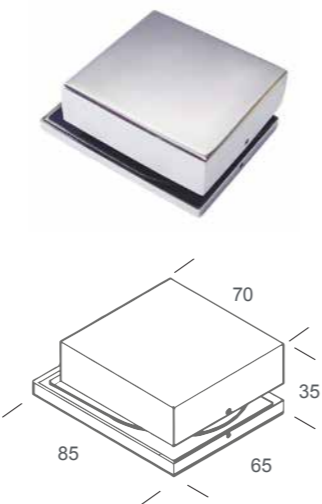

Other fitments

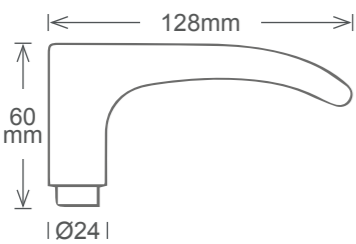

type G handle (oval)

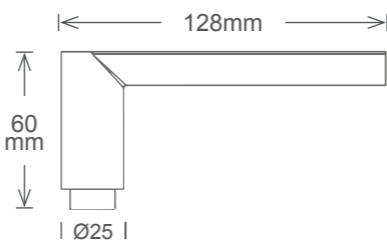

type R handle (square)



lock

Lock 601 for sliding doors

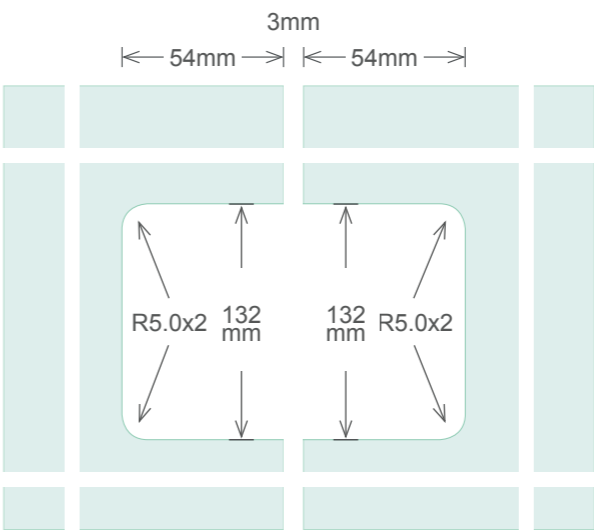

USAF 806 lock

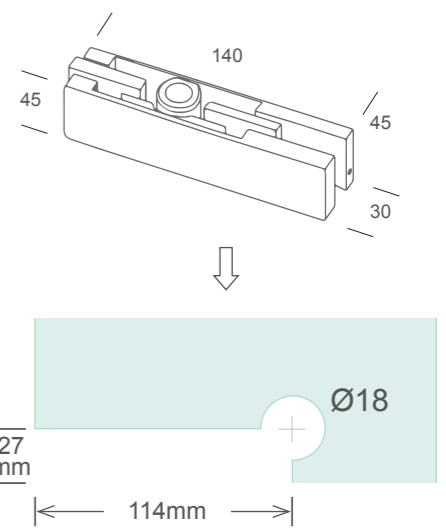
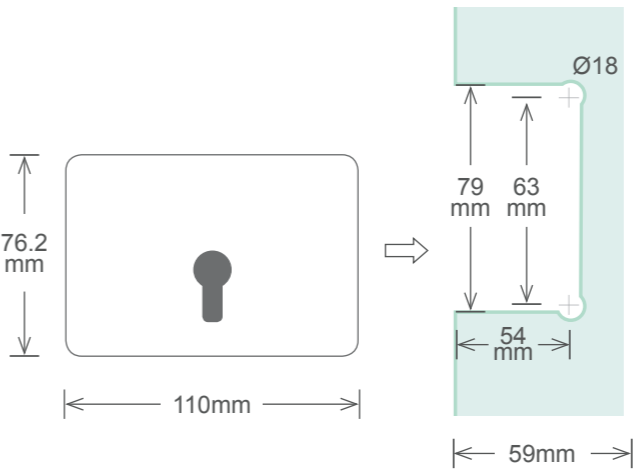

10. Hinges

Type G 101 - oval

x2: B_{max} 36kg
x3: B_{max} 50kg

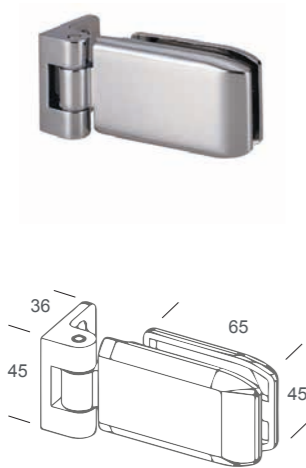

Type R 101 - square

x2: B_{max} 36kg
x3: B_{max} 50kg

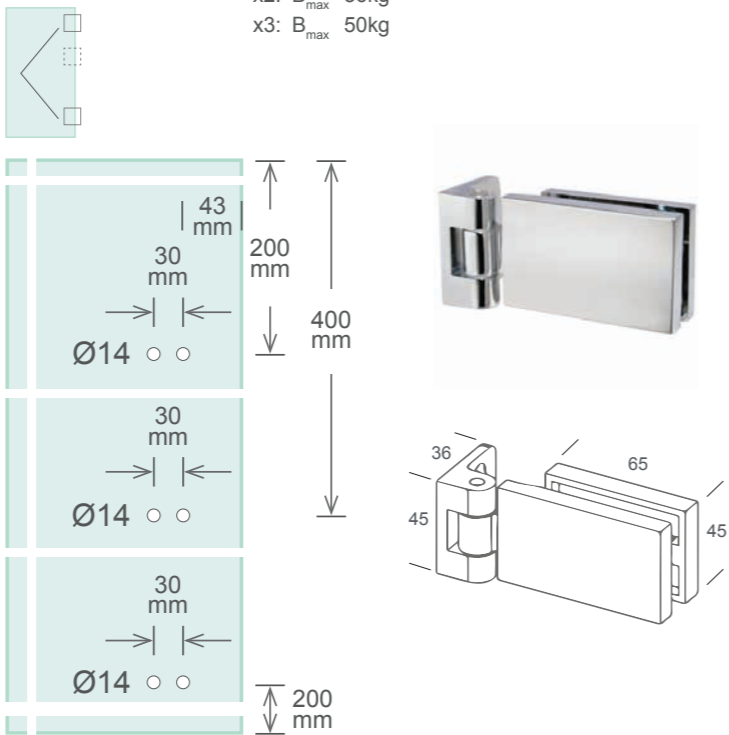

Type G 301 - oval

x2: B_{max} 40kg
x3: B_{max} 55kg

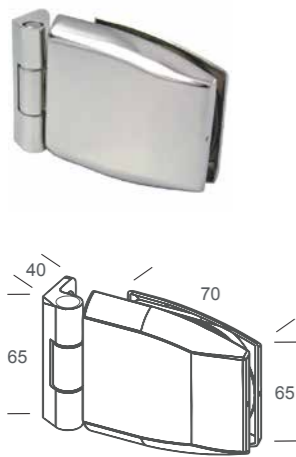

Type R 301 - square

x2: B_{max} 40kg
x3: B_{max} 55kg

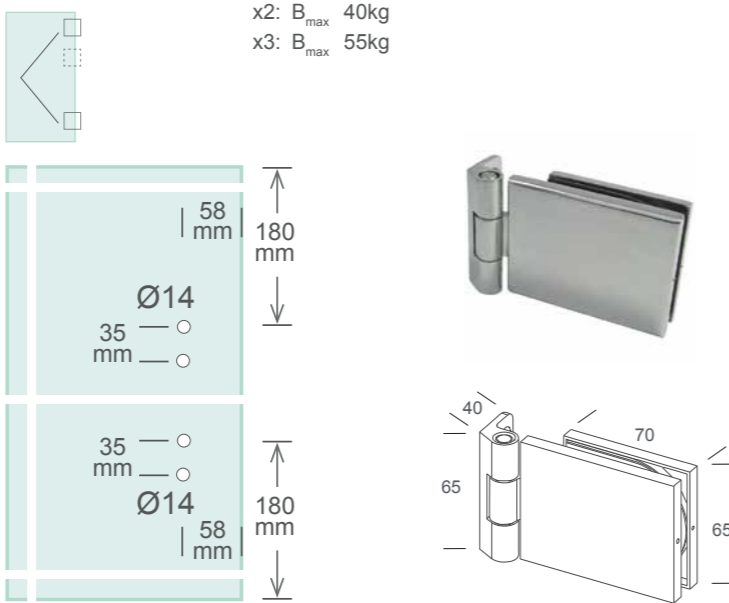

Adjustable wall to glass hinge 700

x2: B_{max} 36kg
x3: B_{max} 55kg

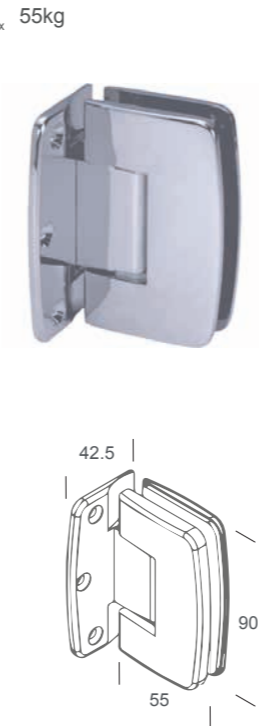

Adjustable wall to glass hinge 701

x2: B_{max} 36kg
x3: B_{max} 55kg

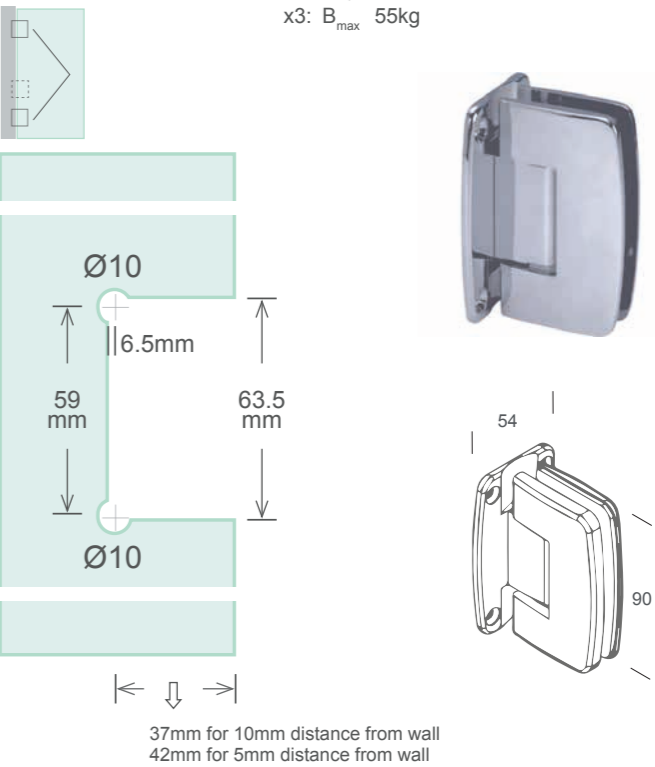

Adjustable hinge with stop glass to glass 180° 703

x2: B_{max} 36kg
x3: B_{max} 55kg

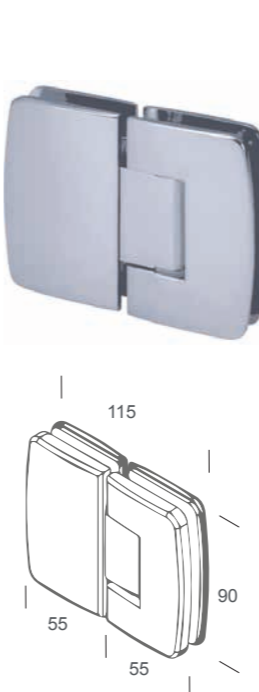

Adjustable hinge with stop glass to glass 90° 703

x2: B_{max} 36kg
x3: B_{max} 55kg

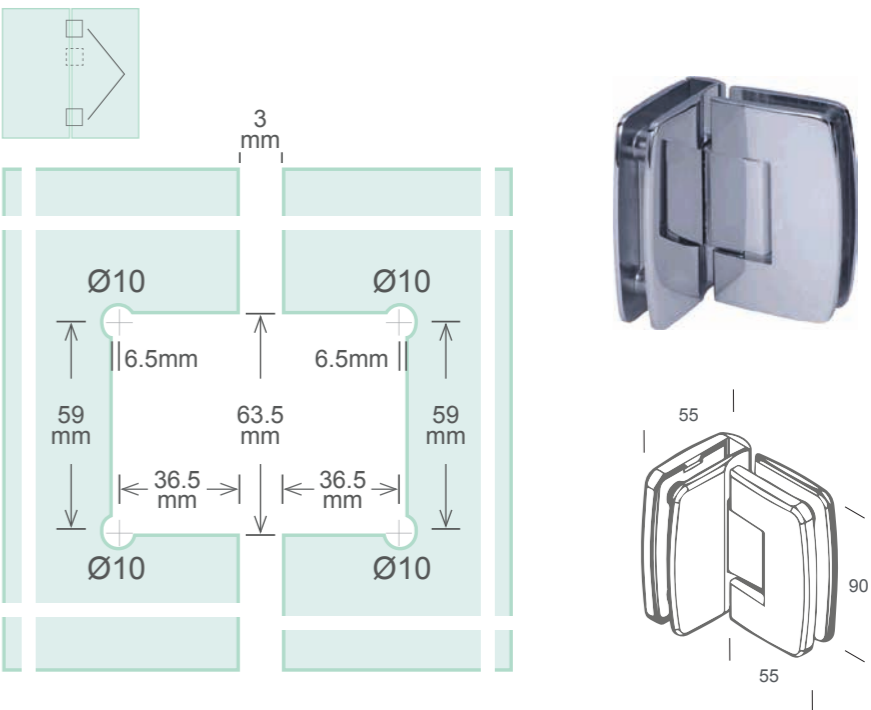

11. Floor-spring mechanisms

USAF 600

Double action. Total hydraulic control with maximum opening angle 130° in each direction. Adjustment valves of swinging speed and latching speed are fully independent, which will save time of adjustment. Securely designed speed adjustment valves protect Floor Spring from rough use or adverse weather conditions. The speed adjustment valves can not be backed out of Floor Spring when adjustment that eliminates oil leakage from the valves. Reduced thickness of 40 mm only safely for thinner slab. Maximum door width 1100 mm, maxim door weight 100 kgs.

25Nm - 1000mm (medium) EN3
33Nm - 1100mm (heavy) EN4

Box dimensions: 307mm x 108mm x 40mm

USAF 610

Double action. Interchangeable spindle tip, extension up to 50 mm. For all kinds of door bottom rails. Total hydraulic control with maximum opening angle 130° in each direction. Adjustment valves of swinging speed and latching speed are fully independent, which will save time of adjustment. Securely designed speed adjustment valves protect Floor Spring from rough use or adverse weather conditions. The speed adjustment valves can not be backed out of Floor Spring when adjustment that eliminates oil leakage from the valves. Reduced thickness of 40 mm only safely for thinner slab. Maximum door width 1100 mm, maxim door weight 120 kgs.

25Nm - 1000mm (medium) EN3
33Nm - 1100mmv (heavy) EN4

Box dimensions: 307mm x 108mm x 40mm

USAF 615

Economic type, good for door width up to 900 mm. Adjustable Swing speed and latch speed independently. Controlled by 2 valves.

Box dimensions: 274 mm x 97 mm x 40 mm

20Nm - 900mm (light) EN2

USAF 635

Double action and single action. Wing speed and Latch speed are controlled independently by 2 valves. Full open 180°, Hydraulic control 110°. Speed adjustment valve can not be backed out of closer when adjustment that eliminates oil leakage from valves.

25Nm - 1000mm (medium) EN3

Box dimensions: 277mm x 130mm x 70mm

USAF 650

Adjustable Spring Tension from 23 Nm to 58 Nm. (EN3~EN6). Supports door weight up to 300 kgs, door width 1.4 meters. Efficiency up to 65%. Interchangeable spindle tips extension up to 50 mm. Swing speed from 180° to 15°, latch speed from 15° to 0°. Cement case 341 mm x 78 mm x 60 mm. Single action for fire door. Full open 180°, no hold open.

Box dimensions: 283mm x 182mm x 48.5mm

USAF 690

Completely recessed mechanism into aluminum bar 4.445cm x 10.16cm and full hydraulic control with max 90°, 105° or 130° to all directions. Fully adjustable for every size and need. Independent valves for rotational and tension adjustment, easy to install and configure, and keep the mechanism safe from bad usage and weather. Fully protected from oil leakage

Box dimensions: 283mm x 182mm x 48.5mm

20Nm - 900mm (light) EN2
25Nm - 1000mm (medium) EN3
33Nm - 1100mm (heavy) EN4

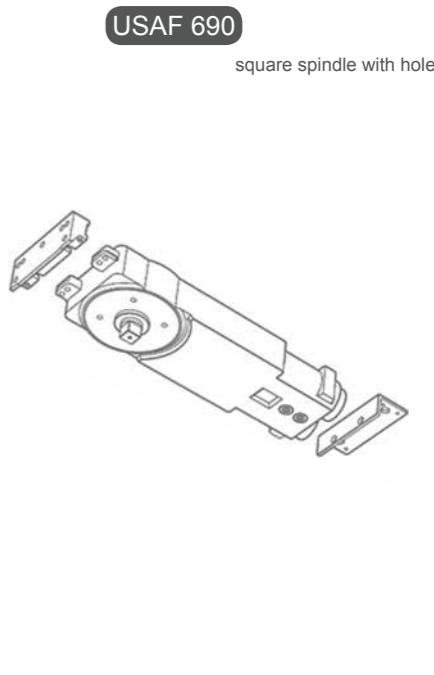
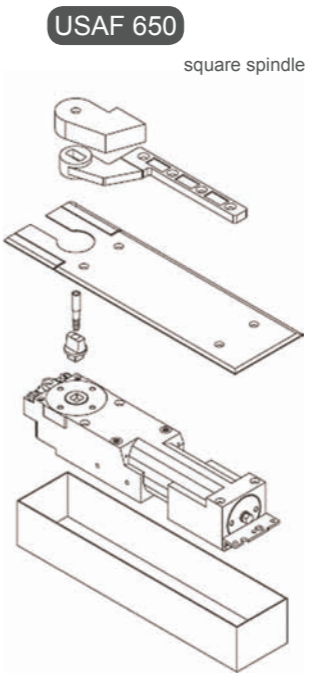
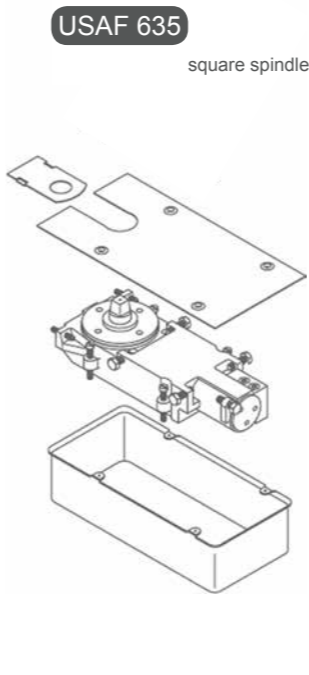
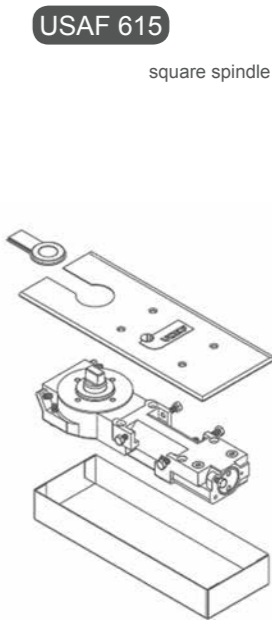
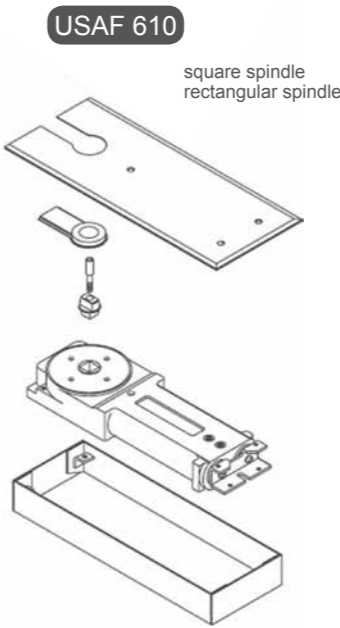
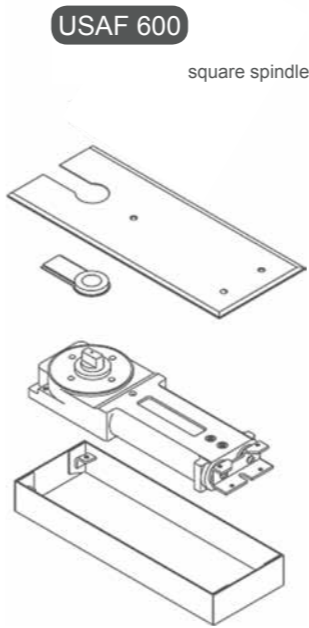

DORMA BTS84

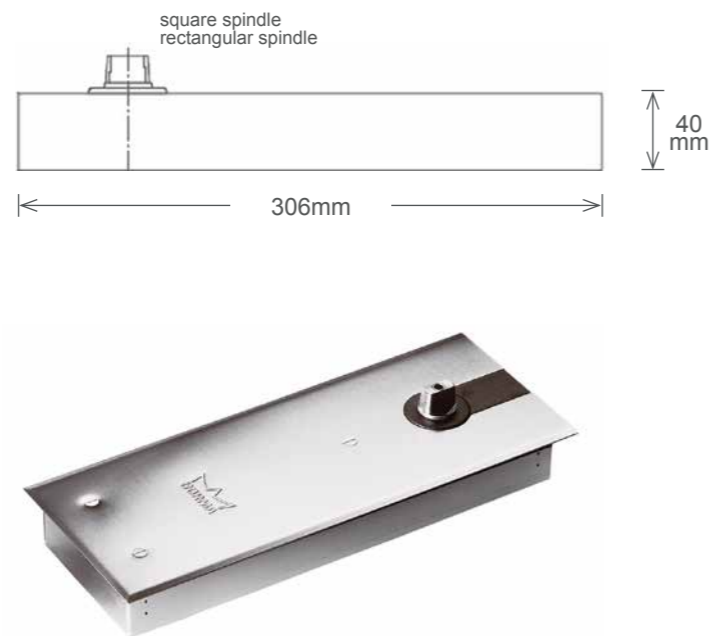
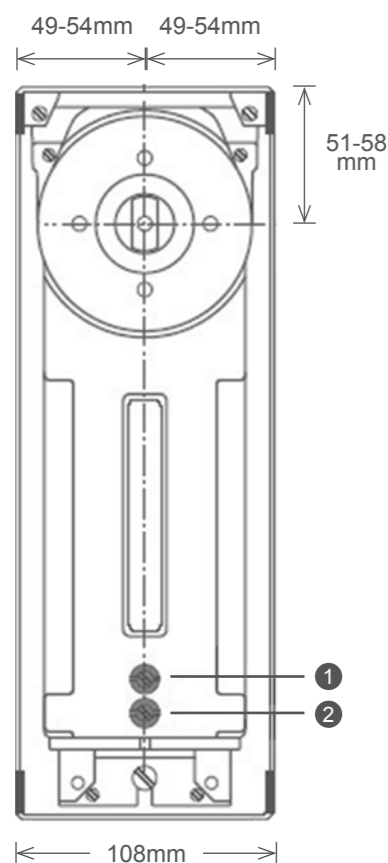

Double action mechanism with special shallow recess design with selectable stop setting, specially modified for the aluminum and glass door industry (ISO 9001), with detachable German and Italian spindle.

Easy to install, adaptable to more demanding circumstances with double valves from 130° to 0° and from 130° to 20°.

- 1 closing speed adjustment valve 130° – 0°
- 2 increasing closing speed adjustment valve 130° – 20°

Fully recessed in very shallow depths in flooring, with proven durability for doors up to 100kg, without thermal fluctuations and highly efficient for easy door opening.

25Nm (medium)
33Nm (heavy)

EN3
EN4

DORMA BTS75

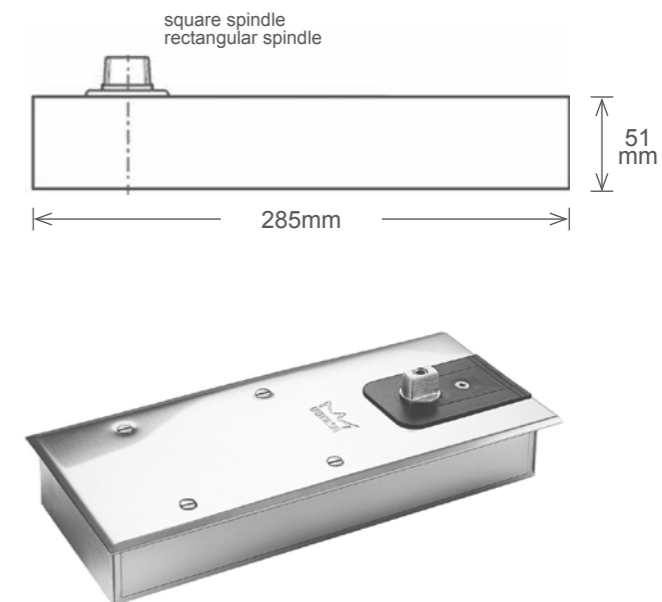
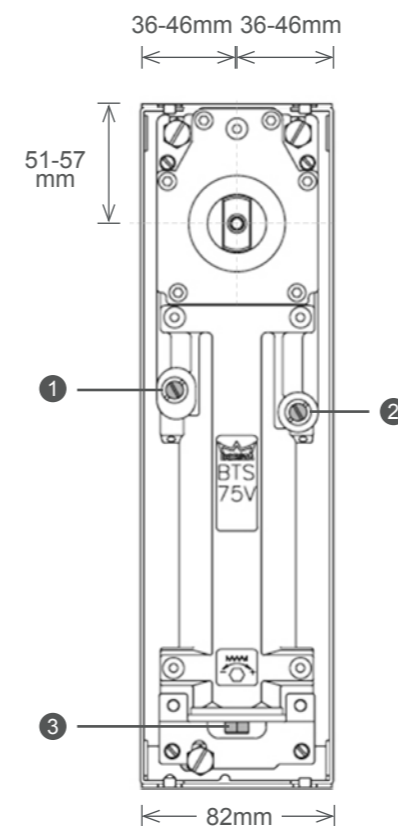

Fully recessed mechanism, adaptable in nearly any condition. The mechanism's small body allows usage where usage of larger mechanisms would be impossible. Mechanism's adaptability allows its installation into shallow cement surfaces.

Adjustable spring allows for the necessary adjustment for opening with and without obstacles, for maximum versatility.

Trouble free, even under bad weather conditions, and/or high frequency usage.

- 1 closing speed adjustment valve 130° – 0°
- 2 increasing closing speed adjustment valve 130° – 20°
- 3 spring tension adjustment

13Nm
20Nm (light)
25Nm (medium)
33Nm (heavy)

EN1
EN2
EN3
EN4

SPEEDY M25

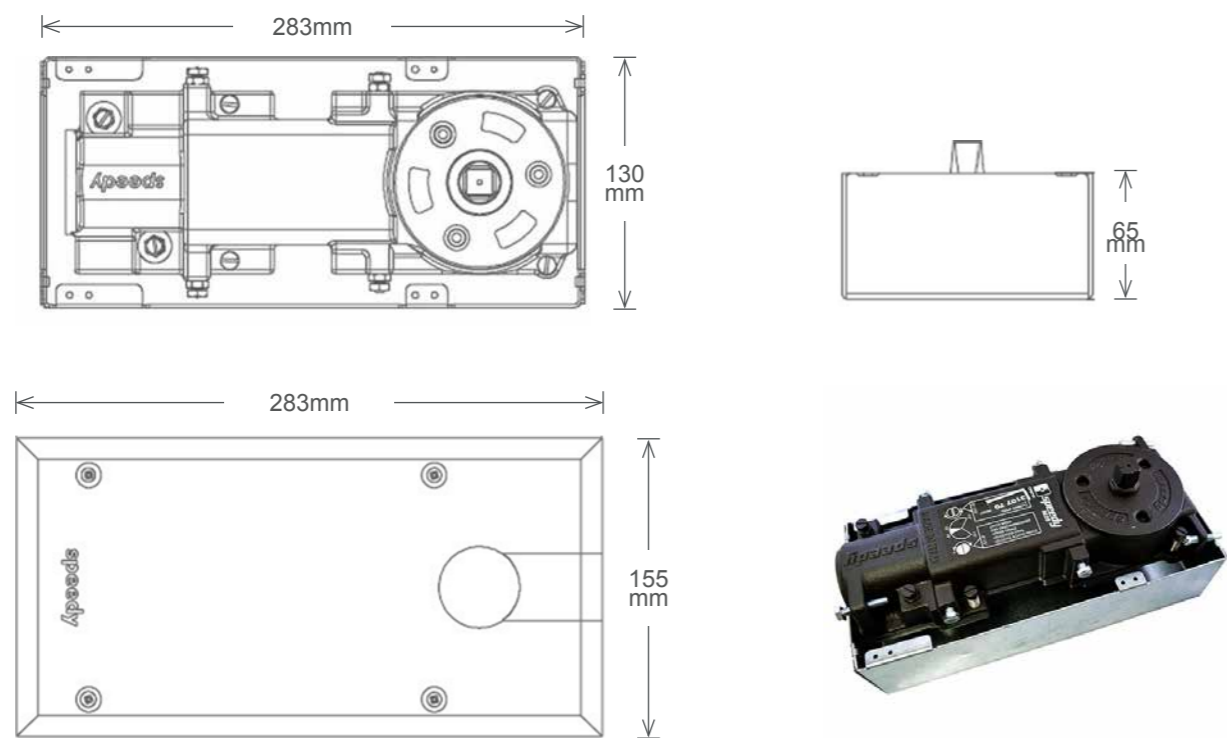

Adjustment without opening the case. Quickly put together with only 4 screws. Two independent oil circulation networks for the adjustment of the closing speed: one for angles 115° to 15°, and from 15° to 0°. Thermal stability upon order for constant volume in case of temperature fluctuation, as well as for doors weighing more than 350kg. Factory settings cover 90% of doors while another two adjustments cover the rest. Selectable spindle. Ideal for extremely demanding environments.

- 20Nm (light)

25Nm (medium)

33Nm (heavy)
- EN2

EN3

EN4



84 Konstantinoupoleos Str.
Acharnes 13671 Athens

T : (+30) 210 23 84 137 / 210 23 19 566
F : (+30) 210 23 17 585 / 210 23 17 618

E : info@salinox.gr